

CORPORATE PROFILE

www.elidzstp.co.za



SCIENCE &
TECHNOLOGY
PARK



innovation happens here

NEVER BEFORE IN HISTORY HAS
**INNOVATION
OFFERED
PROMISE**

OF SO MUCH TO SO MANY
IN SO SHORT A TIME.

- Bill Gates



WE ALL ABOUT INNOVATION

The East London Industrial Development Zone (ELIDZ), established in 2003, is a prime industrial park offering customised solutions for various industries including automotive, agro-processing, renewable energy, ICT, and advanced manufacturing. It offers growth-oriented companies a specialized manufacturing platform, innovative industrial and business solutions and access to new markets and strategic industry networks. With the aim of further accelerating the pace of economic development of the region, a Science and Technology Park (STP) was conceptualized to coordinate innovation initiatives, encourage, and support startup and incubation of innovative, high growth knowledge and technology-based businesses and to further foster development and application of high technology to industry.

Strategically the ELIDZ STP, aims to grow high technology producing companies and encourage new tenants to set up within the zone by offering several innovative products and services. In essence, this is achieved through a dual process of establishing both research and networking infrastructures.

A range of laboratories was established to provide capabilities to tenants of the ELIDZ as well as the region at large. An accredited analytical and testing facility exist.

A innovation ecology is facilitated to support research which will have been commissioned by government, tertiary institutions, ELIDZ tenants, private sector clients based on a broadly consulted research and innovation agenda.

This research and innovation agenda stimulates economic growth within the Eastern Cape as it encourages innovators and their start-up companies to locate themselves within ELIDZ where they will have access to various innovation funders as well as incubation services.

The ELIDZ STP aims to facilitate creative, technical solutions to problems - to assist companies adopt innovative approaches in all their operations, whether it leads to new products and services, or a new improved version of an existing offering, through improved processes.

Interactive and attractive workspaces exist to aid in the creation of a functional innovation ecology that not only allows for an effective and efficient exchange of ideas, but also results in the activation of a wide range of funding streams and joint partnerships which support innovation and commercialisation.

This dynamic and supporting environment is designed to enable innovators to focus on developing innovations, while incubation support services assist in ensuring that the commercial, legal, and intellectual property dimensions of operations are taken care of.

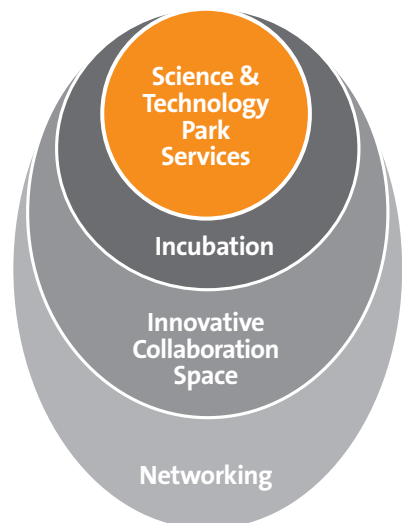

A STRATEGIC APPROACH

THE ELIDZ'S STP AIMS TO:

Increase the competitive and comparative advantage of the ELIDZ by increasing the demand for and the capacity to generate relevant innovations.

THIS WILL BE ACHIEVED THROUGH A 3 WAY APPROACH:

Establishing a capability that will ensure the rapid development of innovations which can be showcased as prototypes or technology demonstrators, offering services that would support innovation and industry as well as offering incubation support

MEET THE INNOVATION TEAM



LUDWE MACINGWANE
Operations Manager: STP



AYANDA NDINISE
*Industrial Design and Skills
Development Specialist*



KHAYAKAZI NONKONYANA
*Laboratory Supervisor
ELIDZ Analytical Laboratory*



XHOBANI SIBEKO
Business Development Facilitator



KAYLENE BELL
Project & Administration Officer

SERVICES

ELIDZ ANALYTICAL LABORATORY

The ELIDZ Consulting and Analytical Services (CAS) Laboratory established in 2014, is a fully accredited laboratory by the South African National Accreditation System (SANAS), situated at the ELIDZ Science and Technology Park (STP). The ELIDZ CAS Laboratory, boasting state-of-the-art equipment, enhances the analytical testing capabilities for the water, food, and soil testing services.

The ELIDZ CAS Laboratory adheres to government and industry regulations, which establish guidelines for acceptable pathogenic and non-pathogenic micro-organisms in specific samples and the food groups. It also ensures compliance by following green drop specifications and adhering to SANA 241, which serves as a benchmark for environmental testing.

The CAS Laboratory is staffed with skilled scientists, offering a wide spectrum of chemical and microbiological analysis services.

In our laboratory, we analyse various types of samples, including:

Water Testing:

- Potable Water Analysis
- Wastewater Analysis
- Surface Water Quality Testing
- Groundwater Monitoring
- Industrial Effluent Analysis

Food Testing:

Microbiological Analysis (pathogens and non-pathogens)

Under expansion

- Nutritional Labelling
- Pesticide Residue Testing
- Allergen Detection
- Contaminant Analysis (Heavy Metals, Mycotoxins, etc.)

Soil Testing:

- Nutrient Analysis
- Soil pH and Electrical Conductivity
- Contaminant Screening
- Soil Fertility Assessment
- Organic Matter Content

Laboratory Facilities: our laboratory is committed to excellence, leveraging state-of-the-art technologies and adheres to international quality standards. We utilize cutting-edge equipment for analysis; spectrometry, and electrometric analysis to ensure the accuracy and precision of our results.

Quality Assurance: ELIDZ Lab is committed to maintaining the highest level of quality assurance. Our quality control protocols include regular calibration of equipment, participation in proficiency testing programs, and adherence to stringent laboratory procedures. We are accredited by South African National Accreditation System (SANAS) and follow industry best practices.





THE BEST WAY
TO PREDICT THE
FUTURE IS TO
**INVENT
IT** - ALAN KAY

Expert Team: Our strength lies in our expert team, a group of highly qualified and seasoned scientists, chemists, microbiologists, and technicians, each bringing a wealth of diverse expertise to our comprehensive laboratory services.

To stay at the forefront, we prioritise continuous training and professional development of our team members. The commitment ensures that our experts remain well-versed in the latest advancements in analytical techniques. We empower our team to navigate the ever-evolving landscape of innovation.

Clientele: ELIDZ Laboratory serves a wide range of clients, including:

- Assisting municipalities with their blue drop and green drop compliance,
- Environmental monitoring for industrial organizations,
- Assisting agricultural enterprises with Good Agricultural Practices (GAP) compliance,
- Food producers and resellers for pathogen testing,
- Abattoirs for hygiene testing to prevent food-borne diseases.
- We collaborate with clients to tailor our testing services to meet their specific needs.



ELIDZ DESIGN CENTRE

The ELIDZ STP Design Centre provides a hands-on learning experience, creating a wealth of knowledge enrichment opportunities. Fully equipped with state-of-the-art facilities, the Centre comprises of services ranging, but not limited to training and skills development services as well as product and prototype development. This is ideal for a diverse range of stakeholders such as individuals, corporates, municipalities, Small Medium, and Micro Enterprises (SMME), Non-Governmental Organisations (NGO) and State-Owned Entities (SOE) who are seeking to develop their own prototypes/products at affordable and subsidized rates. This opportunity is equally suitable for individual projects and joint collaborations.

Our thriving Design Centre boasts the following facilities:

Engineering machinery:

Computer Numerical Control Lathe Machine (Haas St 10)

- shape a round steel bar or a shaft
- reduce the size.
- drill a hole on a shaft/bar to a specific measurement.
- work with round shapes.
- can do round threads.

Laser Engraver & Cutting Machine (Speed 100)

- Engraves on steel, Perspex, cardboard, wood, paper, glass, plastics, leather, aluminium.
- Cut: Perspex, paper, cardboard, wood, leather
- for any shape

3D printers:

- Ultimate maker 1
- Ultimate maker 3 extended
- Zotrex
- Up mini

All the above can print any shape size limited to the platform (height, width, area).



RENEWABLE ENERGY CENTRE

The Renewable Energy Centre situated within the East London Industrial Development (ELIDZ) Zone Science and Technology Park (ELIDZ) was established in response to the current and anticipated growth in South Africa's "Green Economy". In partnering with various stakeholders in the ecosystem, the centre intends to lead in the development and advancement of green economy related skills not only within the Eastern Cape region, but across South Africa, along with the rest of the African continent.

The services offered by the centre are aimed at a number of target groups within the renewable energy sector, including:

- Qualified artisans interested in enhancing their skills within the field of renewable energy.
- Graduates preparing for/pursuing careers related to renewable energy.
- Skilled workers seeking to acquire additional training to participate in both the construction and maintenance phases of various renewable projects in South Africa.
- Management and decision-makers in both public and private sectors.
- Current and potential investors interested in the sector.
- Small Medium and Micro Enterprises (SMMEs) and Cooperatives operating in the sector.

COLLABORATION WORKSPACES – INNSPACE

The latest design techniques were used to create an impactful, interactive, and an attractive workspace for entrepreneurs, incubators and industry to collaborate on projects to conceive, investigate and innovate ideas. With a seating capacity around 30 people, the workspace features boardrooms and a training venue available for hire, which can be utilized for meetings and other business engagements. The STP provides high quality hot desk space to knowledge-based enterprises and furthermore, allows multiple workers using a single physical workstation or surface during different times. This is a collaborative workspace designed to stimulate creativity and allow for effective and efficient exchange of ideas.

INTELLECTUAL PROPERTY AND LEGAL ADVISORY SERVICES SUPPORT

The STP provides intellectual property management and legal advisory services to entrepreneurs which encompass conducting novelty searches to determine the originality of an invention, filing provisional and complete patents, conducting trademark searches and prosecuting trademark applications in two classes until they are registered, and the provision of IP Training. This support provides commercial value to the intellectual property of our entrepreneurs, ensuring the rights and safeguarding of their innovations and concepts.

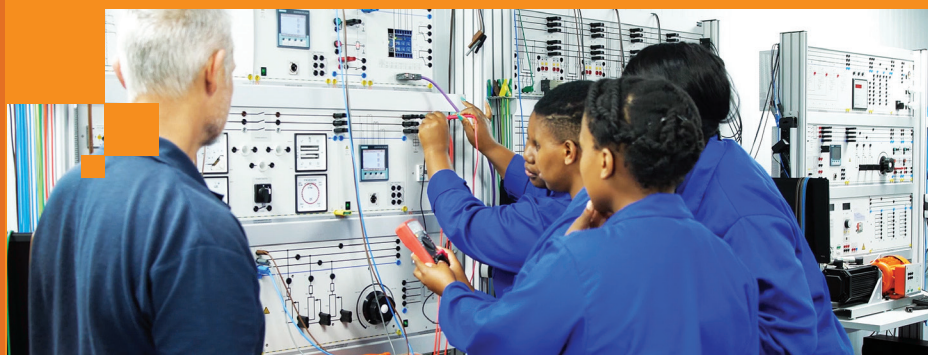

PROTOTYPES

The STP has successfully assisted the following innovators with various resources which includes IP protection, technical and business development support interventions for them to develop their ideas into tangible and demonstrable prototypes:

SAFE PASS™

Provides drivers with a clear view of the road ahead of a slow-moving obstructive vehicle, such as trucks and buses, allowing them to overtake safely. Having a clear view of what is ahead, both directly in front of the vehicle one intends to overtake and traffic in the opposite lane, assists people to make better decisions on when to conduct a “safe pass”.

The system utilizes a proprietary camera system that is fitted to obstructive vehicles, which transmits a live video feed of the road ahead. With a vehicle-based receiver and screen or the use of a smart device with the Safe Pass™ app, drivers wishing to overtake said vehicle, in sync with the video stream will be able to observe the road ahead, before attempting the overtaking manoeuvre without putting themselves or other road users at risk.



COASTAL INNOVATIONS

Turnkey Solid Waste Removal and Aquaponics

Designed to remove suspended solid waste and to circulate a body of water through a centre drain system to plant beds. This system not only offers sustainable growth and progressive agriculture, but also has the potential to produce clean water, high density food and protein while maintaining environmentally friendly standards.

AET AFRICA

The Hot Spot

A geyser sleeve manufactured from EPVC/SPVC plastisol that is fitted over any geyser heating element to transfer hot water from the bottom of the geyser to the top using the thermosyphon principle. The sleeve is fitted over the hot element with normal temperature ranging from 30-60 degrees Celsius. Aiming to improve the geyser efficiency and energy saving, consumers can switch their geysers on and off at their convenience, minimizing the waiting period for hot water as it is accessible to households within 30 minutes of switching on the geyser.



The Heat Raider

Is a waste heat harvester from existing refrigeration and cooling systems designed for commercial applications to make the cooling process more efficient by saving energy and producing free hot water therefore taking the geyser off the grid.

The Heat Raider has proven to provide additional energy savings by reducing the power consumption and effectiveness of cooling systems by 25%, while cutting the electricity bill by 20-27%. Through the utilization of waste energy and heat generated from existing cooling systems, this product provides a more efficient operating range for cooling systems, ensuring saving in operating energy and the longevity of its components, reducing stress due to increased efficiency.



TWERLY

A renewable energy source powered by a Vertical Axis Wind Turbine and PV Panel. The multipurpose product operates as a streetlight, a Wi-Fi hotspot (catering to businesses, universities, and schools) and houses a surveillance camera for utilization in the security industry.



IMPILO YETHU BIOMETRIC APP

An innovative mobile platform aiming at providing immediate service to patients by using their fingerprint through a well-designed software that will be linked to a cloud database and provide registered users (medical professionals) access to subscribed members (patients) full medical history and personal information.



MYSRIPTAPP

A digital prescription & healthcare data management application, this product aims to replace paper-based medical prescriptions in the health care sector and create a dynamic health record as a by-product from the instructions of the doctor to the dispensing of medication by the pharmacist. This user-friendly application is used to prescribe, dispense, pay for medication, and as a reference for future prescriptions. For ease of communication, MyScript provides access to scripts and a record of the medication history of the patient upon request and reduces the red tape regarding prescription medication.

MZAMOBILE

A Mobile money transactions from any bank into a cell phone and withdraw from a retail merchant, primarily spaza shops from townships and rural villages.

MP 24

A custom Mobile APP that acts as a virtual monitoring energy consumption system. It creates the capability between the telecommunication and energy system. The APP itself is run and conducted in a mobile phone then interlinked with a PC BOARD "Smart Prepaid Box" (Tablet form factor) device.

PARK ASSIST APP

A digital parking management system that motorists can use to view in real time vacant/occupied parking bays in a map grid and be navigated to such parking.

iLAB KIT

An onsite portable, scientific validated drinking water testing kit that enables the basic assessment of water quality with minimal physical infrastructure and human resources needs.

LOMAVE INFANT FORMULA

The aim of this project is to devise an infant formula using goat milk to increase the availability of organic micronutrients like mother's breast milk. Bambara groundnut will be used as source of protein, essential vitamins, and minerals. Bambara groundnut is a legume crop which has its origins in the west Africa, grown by women farmers for household consumption.

RECYCLED ASPHALT PLASTIC MIXING MACHINE AND RECYCLED ASPHALT PLASTIC PAVEMENT MATERIAL

The company develops recycled asphalt plastic pavement material and machine which is utilized for pothole repair and gravel road surfacing for low volume traffic under controlled green environmental temperature towards reduction in green-house gas emissions, reduction of landfill waste at dumpsites.

SMART BATTERY BOOSTER

Meant to be replacement of jumper cables, via Bluetooth through your phone and decoy button, you will be able to push to jump start your vehicle wirelessly.

This application allows for customisation into various application scenarios where

administrators, emergency practitioners, doctors and patients can interact with the system for medical information and assistance. The assistance provided includes adding patients on the database, scheduling appointments, updating medical history information, and retrieving it from the cloud storage using a cell phone, biometric device, or a desktop webpage.

TK CBC FOOTWEAR

A footwear company that designs, manufactures, and retails high quality premium sneakers and has three prototyped products that they are looking at manufacturing.

SMART AIRPORT TROLLEY

Designed to be used at airports with a tablet mounted at the handle with main features that include real-time indoor location, flight information portal and marketing platform.

NC-UMO BANK NOTE SANITIZING MACHINE

Providing a centralized knowledgebase where criminal activities can be easily monitored and audited.

SMART SILENT ALARM DETECTOR

By Junior X Team is a device that uses advanced proximity sensors that feeds to a live interactive dashboard.

APP STEM

The APP will have content, quizzes and test and it will be able to grade.

AGRICULTURAL APP

Develop a blockchain system to provide support for small and emerging black farmers with access to information, finance, and market. Also educate farmers about refined methods of farming.

The STP is currently assisting innovators to develop their prototypes and form relationships as well as collaborations with ecosystem partners/stakeholders with the objective to commercialise/market their innovations/concepts successfully.

MEET OUR TENANTS



Afrocentric IP

AFROCENTRIC INTELLECTUAL PROPERTY PTY LTD

Afrocentric Intellectual Property (Afrocentric IP) is a governance, risk, compliance, and collaboration solution provider. Passionate about creating and generating intellectual property innovation, the company has adopted an open innovation model, encouraging collaboration between technology, communities, academic and research institutions, along with civil society.

Through the development of uniquely African innovative intellectual property that seeks to resolve the world's core challenges, their mission is to provide both private and public sectors with customised technology and consulting services that mitigate organisational risks, resulting in IT compliance and governance.



BLAQTRONICS

Blaqtronics is a Level 1 BBEE company incorporated in the Republic of South Africa in 2012 with a prime intention of participating in the South African Information and Communication Technology (ICT) infrastructure service provider market. Blaqtronics seeks to be the pinnacle of telecommunications infrastructure service provision in the Eastern Cape, South Africa and beyond.



CISCO

Committed to support the digitisation of Africa's communities, businesses, and governments through initiatives for skills and talent development, innovation and job creation, the Cisco Incubation Centre is the third of its kind in South Africa, providing enhanced Information and Communication Technology (ICT) skills and technology across the industry sectors to enable growth and innovation. Cisco is a developer, manufacturer and a seller of networking hardware, telecommunications equipment and other high-technology services and products globally. Cisco aims to develop and expand skills while creating new job opportunities for South Africans while fostering access to market for new Small, Medium and Micro Enterprise (SMME) partners in the ICT market space.



KHULA TECHNOLOGY HOLDINGS

Khula Technologies is a well-established dynamic Information and Communications Technology (ICT) Company that specialises in ICT Solutions and Infrastructure. The company is resolute on meeting the country's ICT developmental needs.



EC INTERNET PTY LTD

EC Internet is an internet service provider (ISP) operating in the highly competitive Internet Service Providers industry not only South Africa, but on a global scale by providing consumers with internet connections that are reliable, fast, and affordable. To ensure attainability of the company's ambitions of competing favourably with leading ISP companies such as Afrihost, MWeb and Telkom Internet, an excellent team, one with commendable industry expertise, is supported with world class equipment targeted at meeting and surpassing consumer expectations.



PAICTA

Pan African Information Communication Technology Association ("PAICTA") is inspired by the Pan-Africanism movement of uniting Africans to work together. This organization advocates for SMME's, youth, women, and people with disabilities by creating an integrated and inclusive society through integrated digital platforms. Additionally, it aspires to help improve the quality of life for African citizens through enhanced communities, technology innovation, and digital transformation.



SCHUBART PARK PTY LTD

Schubart Park Design & Product Development is an umbrella business aimed at redeveloping existing concepts in the clothing and textile industries. With the goal of building brands on a strong African heritage while also appealing to the global masses/ while possessing global appeal, the products and services offered are the backbone of clothing and textile industry innovation.



ZONZABA PTY LTD

Established in 2016, Zonzaba Pty Ltd produces baby tonic to assist newborn babies, toddlers and young children struggling with colic, flatulence, stomach spasms and cramps. Rendering services that improve natural product manufacturing, operational performance and medical plant research, the purpose of the company is to deliver sustainable development, environmental and eco-friendly products.



EAST LONDON IDZ SCIENCE & TECHNOLOGY PARK

[ZONE 1C]

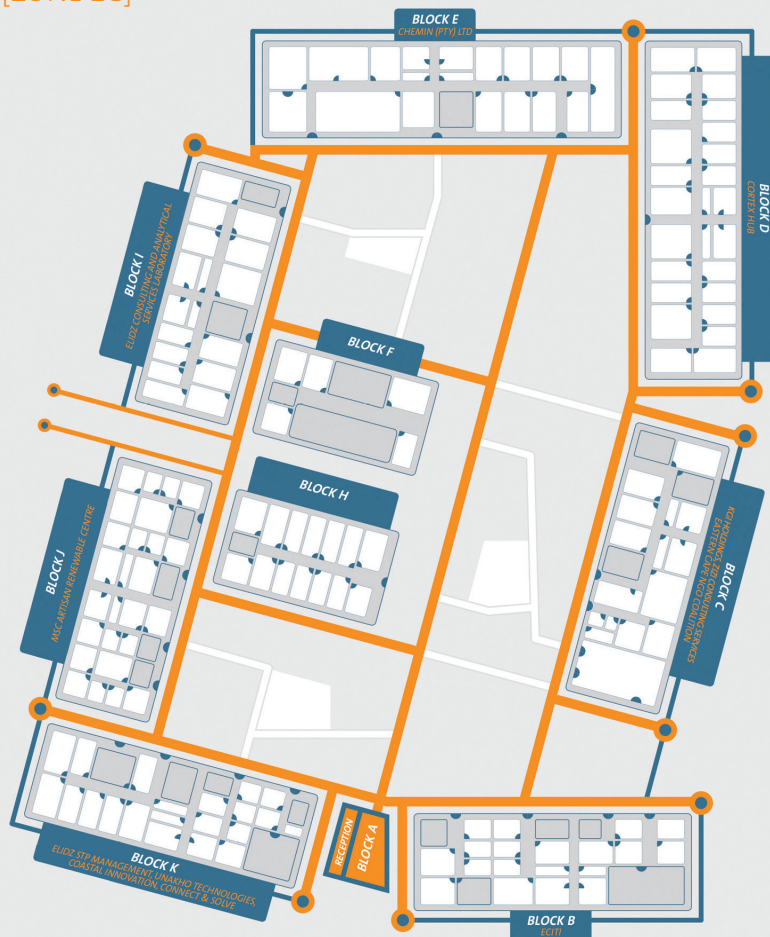

BLOCK A

- FOYER/RECEPTION

BLOCK B

- AFROCENTRIC INTELLECTUAL PROPERTY (PTY) LTD
- KHULA TECHNOLOGIES PTY LTD
- EC INTERNET
- BLAQTRONICS
- PAICTA

BLOCK C

- PAICTA
- ZIZI CONSULTING SERVICES
- BCMM CALL CENTRE

BLOCK D

- STP DIGITAL HUB

BLOCK E

- ELIDZ 3D DESIGN CENTRE
- CISCO EDGE INCUBATION CENTRE

- ZONZABA PTY LTD

- SCHUBART PARK PTY LTD

BLOCK F

- BCMM CALL CENTRE

BLOCK H

- MFURRA PROJECTS
- ABET LIFELONG
- MONZULA
- DEPARTMENT OF ROADS AND TRANSPORT – G-FLEET MANAGEMENT

BLOCK I

- ELIDZ CAS LABORATORY

BLOCK J

- RENEWABLE ENERGY CENTRE OF EXCELLENCE - MASTER OF ARTISAN

BLOCK K

- STP MANAGEMENT
- STP ADMINISTRATION





SCIENCE & TECHNOLOGY PARK

Lower Chester Road, Sunnyridge, East London, 5201

PO Box 5458, Greenfields, East London 5208

Republic of South Africa

Tel: +27 43 702 8217

Fax: +27 86 572 0428

Email: kaylene@elidz.co.za

www.elidzstp.co.za

